

## Light Oil Burner One-Stage

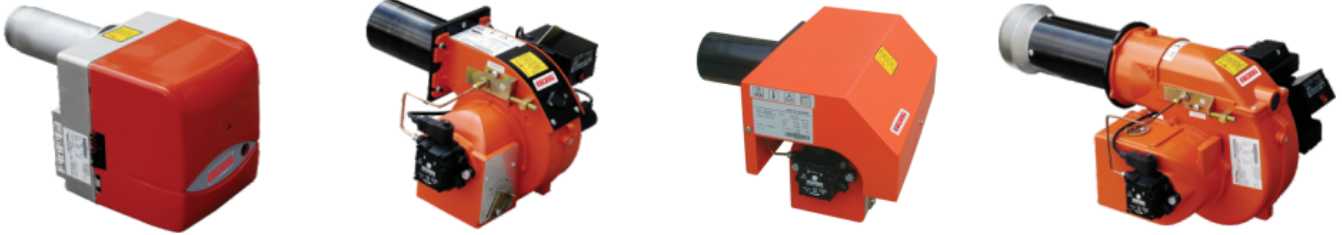

### Technical data

Mode	Output max			Output min. Kcal/h×104	Flow rate max. Kg/h	Flow rate min. Kg/h	Power supply V	Motor KW	Packing Size L×P×H mm	weight Kg
	KW	Kcal/h×10	KW							
M-3LF	42.7	3	8	0.65	3	0.65	230V/50H z	0.09	490×300×320	10
M-6LF	74.3	6	31.9	2.75	6	3		0.11	490×300×320	12
M-10LF	118	10	60	5	10	5		0.11	490×300×320	12
M-14LF	172	14	89	7.5	14	7.5		0.15	470×455×340	15
M-14LFW*	172	14	89	7.5	14	7.5		0.15	480×455×340	17.5
M-18LF	213	18	90	8	18	8		0.37	650×520×385	23
M-26LF	308	26	154	13	26	13		0.37	650×520×385	23
M-35LF	391	34	178	15	34	15		0.37	805×525×405	26
M-40LF	474	40	237	20	40	20	380V/50H z	0.37	1100×600×450	54

\* With waterproof cover

### Curve Diagram

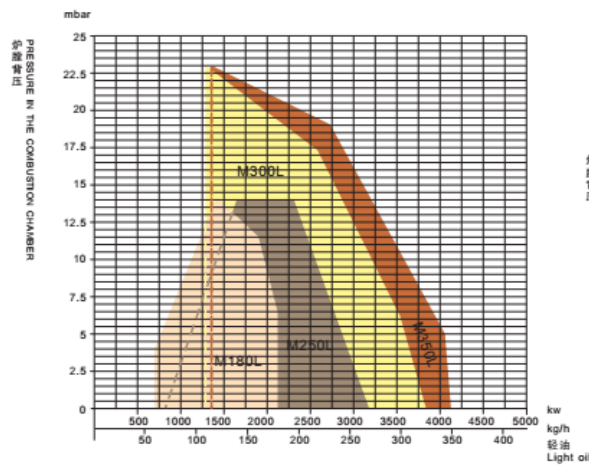
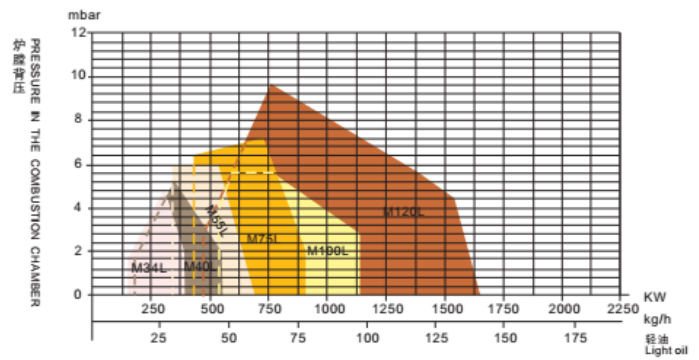
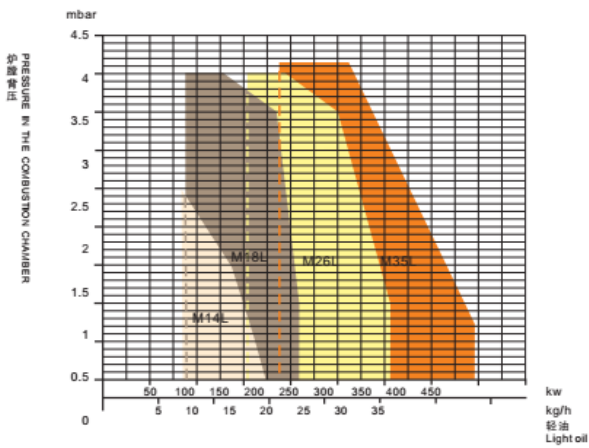
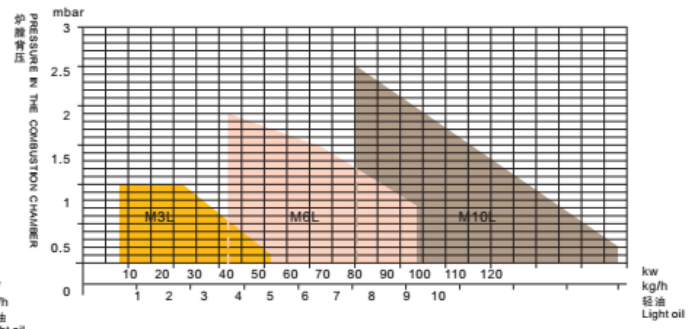
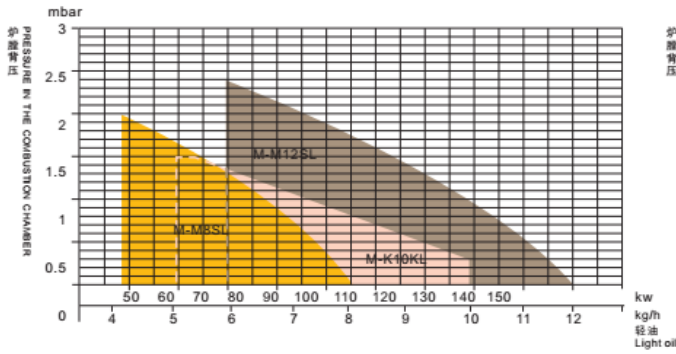

### 平滑/比例式工作范围 Sliding/Modulating curve diagram

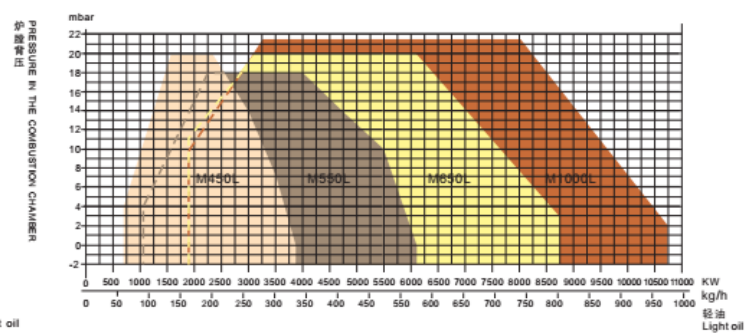

Overall Dimensions

M-K10K, M8S, M12S, 14L

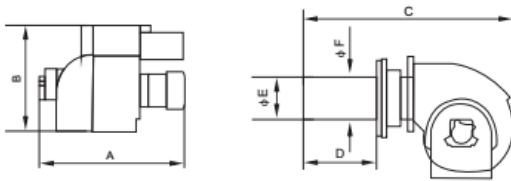

M18L, 26L, 35L

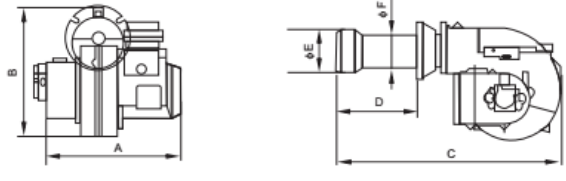

M3L, 6L, 10L

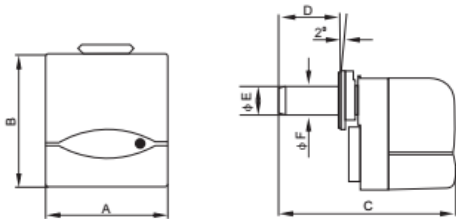

M34L, 40L, 55L, 75L, 100L, 120L, 180L, 250L, 300L, 350L

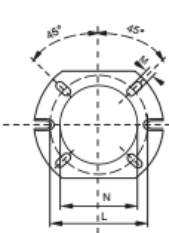
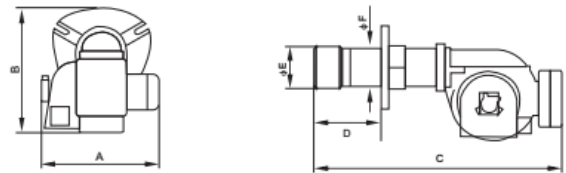

NO.1

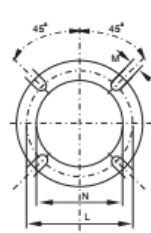

NO.2

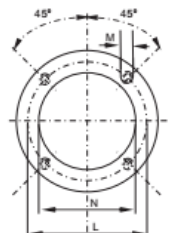

NO.3

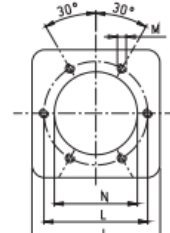

NO.4

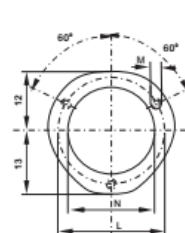

NO.5

Model	A	B	C	D	E	F	L mm The size between the installation holes		N	ømm	M	NO .
							min	max				
M-K10KL	300	230	400	105	90	90	130	155	95	M8	1	
M-8SL	330	220	220	120	89	89	130	155	95	M8	1	
M-12SL	330	220	220	140	89	89	130	155	95	M8	1	
M-3L	250	217.5	330	90	80	80	135	160	90	M8	1	
M-6L	245	270	455	150	90	90	130	155	100	M8	1	
M-10L	245	270	480	130	95	95	130	155	100	M8	1	
M-14L	360	275	415	110	95	95	130	155	105	M8	2	
M-14LW	380	275	415	110	95	95	130	155	130	M8	2	
M-18L	360	355	650	117	118	114	170	206	130	M10	2	
M-26L	450	355	650	139	135	114	170	206	150	M10	2	
M-34L	480	380	740	380	150	135	200	244	165	M12	2	
M-35L	450	372.5	780	350	150	135	200	244	165	M12	2	
M-40L	525	430	985	305	170	135	200	244	180	M12	2	
M-55L	600	500	1170	400	170	135	200	244	180	M12	2	
*M-75L	630	510	1200	400	205	160	233		180	M12	3	
M-100L	640	525	1295	400	230	195	276		240	M16	3	
M-120L	685	610	1400	400	230	195	276		240	M16	3	
M-180L	785	650	1645	535	260	220	339		270	M16	3	
M-250L	915	780	1665	590	260	220	339		270	M16	3	
M-300L	915		1860	605	360		480	510	380	M20		

---

		840				275					5
M-350L	1050	920	1960	560	360	275	480	510	380	M20	5

"W" With waterproof cover

"N" means the size of the hole on the chamber.

When "E" is greater than "N", besides without furnace door on this boiler, please open the hole "N" greater than "E" and need one extravagant flange to install the burner. Contact sell office if need any more details.

Product link : <https://www.eburn-burner.com/?p=1116>